

ANCHOR BOLT LAYOUT PLAN @ PART 'C'
(REF-S101c)

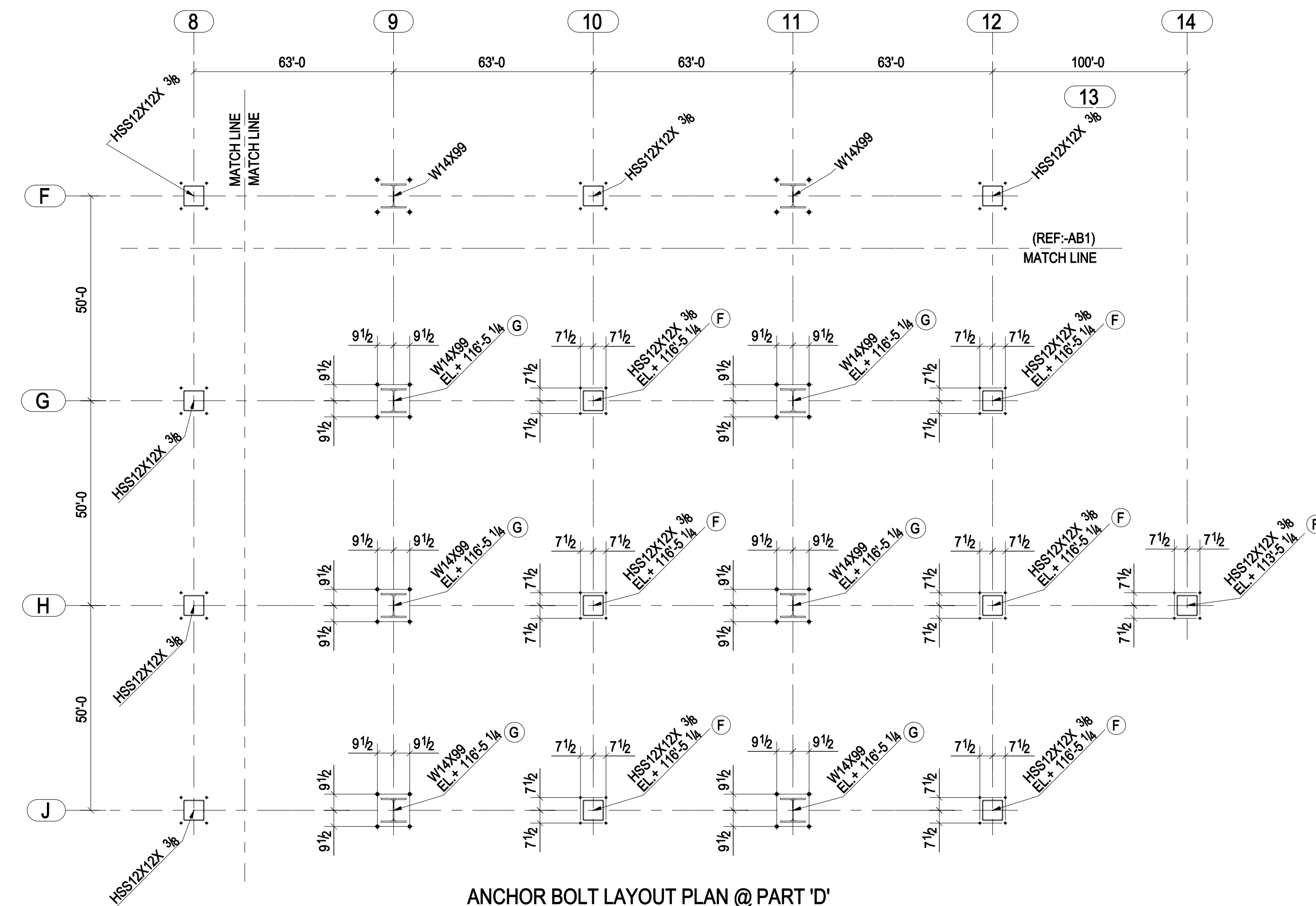

ANCHOR BOLT LAYOUT PLAN @ PART 'D'
(REF-S101d)

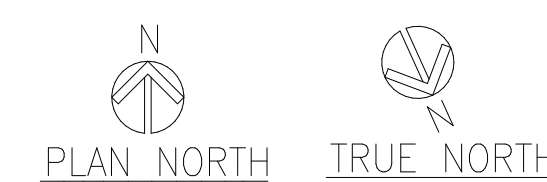
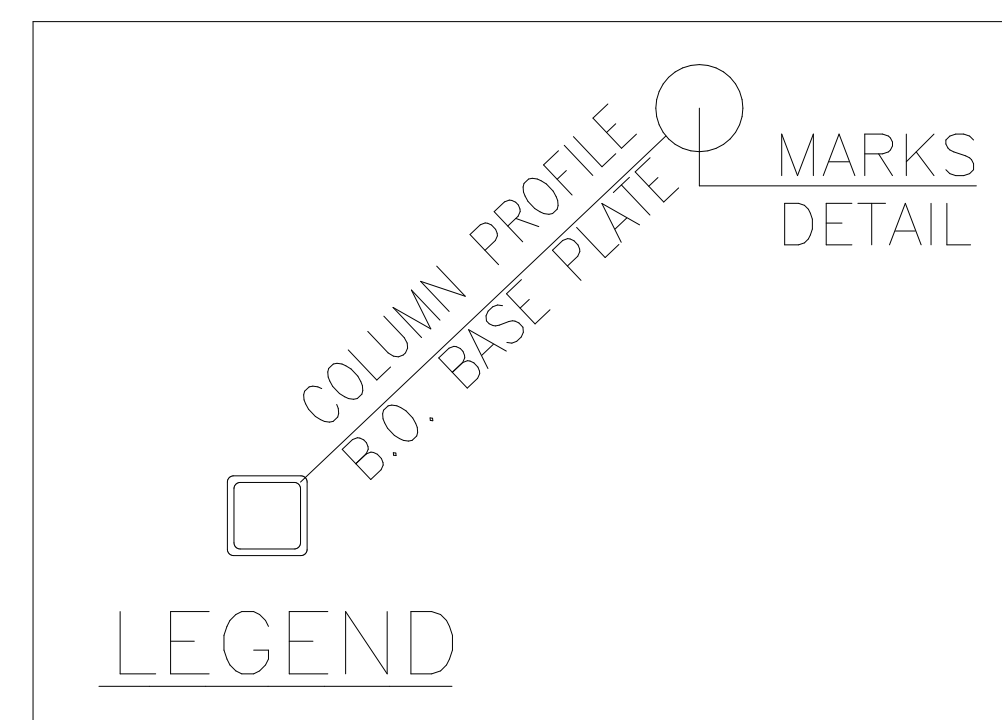
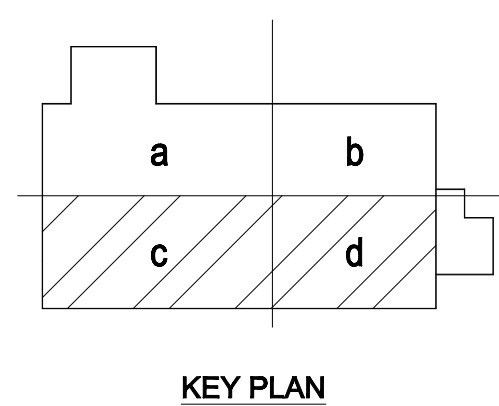

04/18/14 FOR FIELD						
PRINT RECORD						
DATE	APP.	SHOP	FIELD	DIST.	COORD.	F.C. OFFICE
SHOP DRAWING DISCLAIMER						
ALL INFORMATION PROVIDED ON THESE DRAWINGS ARE PREPARED IN ACCORDANCE TO THE CONTRACT DOCUMENTS AND THE SPECIFICATIONS. ALL DIMENSIONS SHOWN ARE DUE TO LACK OF INFORMATION PROVIDED BY THE CONTRACT DOCUMENTS OR SPECIFICATIONS, BUT PREPARED WITH ALL THE INFORMATION AVAILABLE TO US. WE MUST HAVE THESE DIMENSIONS ANSWERED BY THE GENERAL CONTRACTOR, ARCHITECT, ENGINEER, BEFORE WE CAN START FABRICATING ANY MATERIAL. PLEASE RESPOND WITH THIS INFORMATION BY MARKING UP OUR SHOP DRAWINGS.						
MATERIAL:	HOLE SIZE:	BOLT GRADE:	MINIMUM WELD:	ELECTRODE:		
A36 UNO	13/16" Ø UNO	A325-N UNO	3/16"	E-70XX		
ARCH:				JOB NAME & LOCATION:		
ENGR:						
CONTR:						
REF:						JOB: 14-105
DRAWN BY: RN 04/18/14 CHECKED BY: RKB 04/18/14						SHEET: AB2
SHEET TITLE: ANCHOR BOLT LAYOUT PLAN @ PART 'C' & 'D'						
MODIFIED DATE: 04/18/14						LAST PLOT DATE: 04/18/14 CAD FILE NAME: 1