

ONE - POST - 161P1

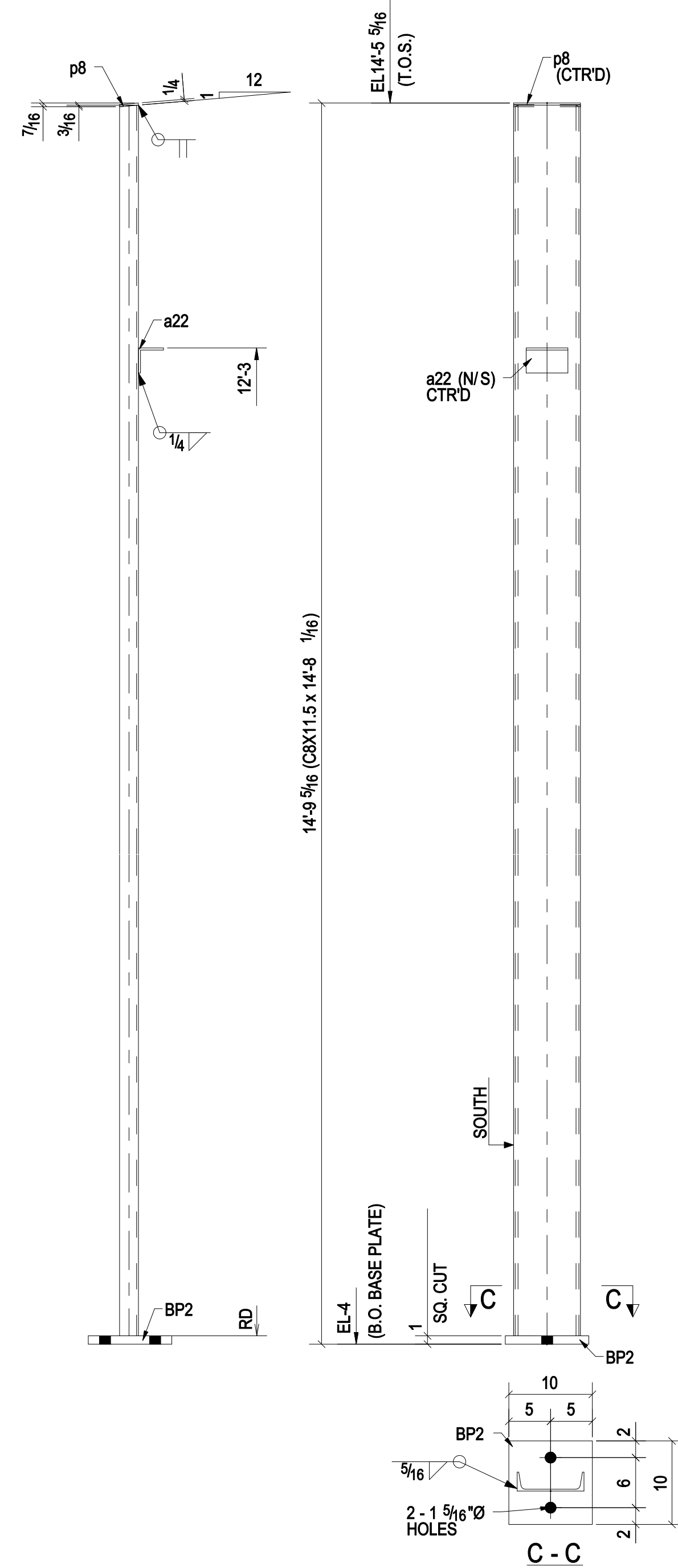

ONE - POST - 161P2

BILL OF MATERIAL

MARK	QTY	DESCRIPTION	LENGTH	WEIGHT	REMARKS
161P1	1	POST			
161P1	1	C8X10.5	13'-8 3/4"	142	A36
BP2	1	FL1"X10"	0'-10"	28	A36
p7	1	PL14"X2"	0'-0"	1	A36
p68	1	PL12"X8 1/8"	0'-10 5/8"	8	A36
p69	1	PL12"X8 1/8"	0'-10 5/8"	8	A36
161P2	1	POST			
161P2	1	C8X11.5	14'-8 1/16"	168	A36
BP2	1	FL1"X10"	0'-10"	28	A36
a22	1	L3X3X1/4	0'-0"	2	A36
p8	1	PL14"X2 1/4"	0'-0"	1	A36
TOTAL WEIGHT THIS DRAWING				388	

PROJECT PHASING		
MARK	QTY	PHASE
161P1	1	Phase 1
161P2	1	Phase 1

<p>05/26/14 FOR APPROVAL</p> <p>PRINT RECORD</p>		<p>SHOP DRAWING DISCLAIMER</p> <p>ALL INFORMATION PROVIDED ON THESE DRAWINGS ARE PREPARED IN ACCORDANCE TO THE CONTRACT DOCUMENTS AND THE SPECIFICATIONS. ALL CLOTTED AREAS SHOW ARE DUE TO LACK OF INFORMATION PROVIDED BY THE CONTRACT DOCUMENTS OR SPECIFICATIONS, BUT PREPARED WITH ALL THE INFORMATION AVAILABLE TO US. WE MUST HAVE THESE AREAS ANSWERED BY THE GENERAL CONTRACTOR, ARCHITECT, ENGINEER, BEFORE WE CAN START FABRICATING ANY MATERIAL. PLEASE RESPOND WITH THIS INFORMATION BY MARKING UP OUR SHOP DRAWINGS.</p>						
DATE	APP.		SHOP	FIELD	DIST.	COORD.	F.C.	OFFICE
MATERIAL: A36 UNO		HOLE SIZE: 13/16" Ø UNO		BOLT GRADE: A325-N UNO		MINIMUM WELD: 3/16"		ELECTRODE: E-70XX
ARCH:				JOB NAME & LOCATION:				
ENGR:								
CONTR:								
REF:		JOB: 14-111		DRAWN BY: AK		SHEET: 161		
DATE: 05/26/14		CHECKED BY: SK		DATE: 05/26/14		SHEET: 161		
MODIFIED DATE: 05/28/14		LAST PLOT DATE: 05/28/14		CAD FILENAME: 161				