

**ANCHOR BOLT LAYOUT PLAN (SECTOR A)**  
(REF. - S2.0A)

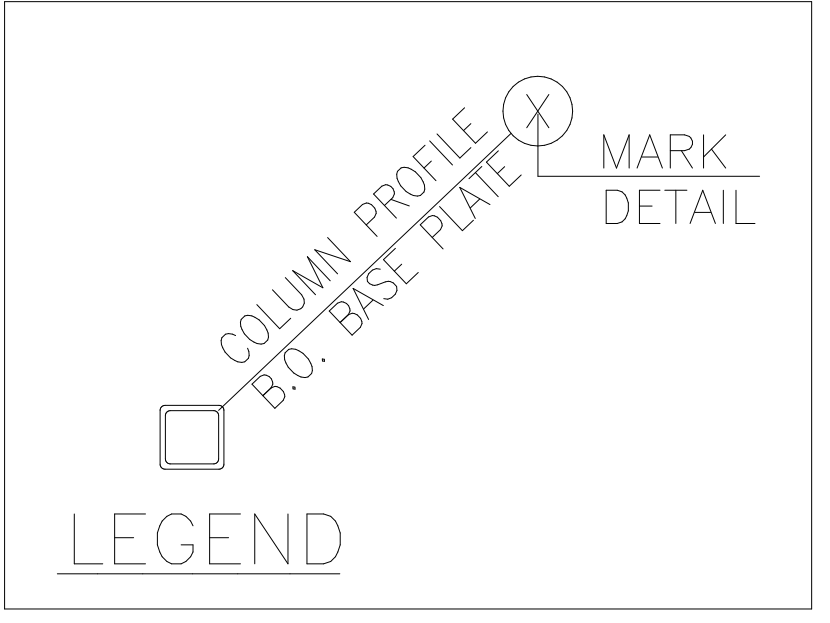

NOTES:-  
1. APPROVER PLEASE VERIFY/ PROVIDE ALL CLOUDED PORTIONS.

<b>FOR APPROVAL</b> DATE: 05/26/14 APP. SHOP FIELD DIST. COORD. F.C. OFFICE						<b>SHOP DRAWING DISCLAIMER</b> <small>ALL INFORMATION PROVIDED ON THESE DRAWINGS ARE PREPARED IN ACCORDANCE TO THE CONTRACT DOCUMENTS AND THE SPECIFICATIONS. ALL CLOUDED AREAS SHOW WE ARE TO LACK OF INFORMATION PROVIDED BY THE CONTRACT DOCUMENTS OR SPECIFICATIONS, BUT PREPARED WITH ALL THE INFORMATION AVAILABLE TO US. WE MUST HAVE THESE AREAS ANSWERED BY THE GENERAL CONTRACTOR, ARCHITECT, ENGINEER, BEFORE WE CAN START FABRICATING ANY MATERIAL. PLEASE RESPOND WITH THIS INFORMATION BY MARKING UP OUR SHOP DRAWINGS.</small>	
<b>PRINT RECORD</b> DATE APP. SHOP FIELD DIST. COORD. F.C. OFFICE							
MATERIAL: A36 UNO		HOLE SIZE: 13/16" Ø UNO		BOLT GRADE: A325-N UNO		MINIMUM WELD: 3/16"	ELECTRODE: E-70XX
ARCH: _____ JOB NAME & LOCATION: _____ ENGR: _____ CONTR: _____							
REF: _____ DRAWN BY: PC 05/26/14 CHECKED BY: SK 05/26/14 SHEET TITLE: ANCHOR BOLT PLAN (SECTOR A)						JOB: 14-111 SHEET: <b>AB1</b>	
MODIFIED DATE: 05/28/14 LAST PLOT DATE: 05/28/14 CAD FILENAME: AB1							

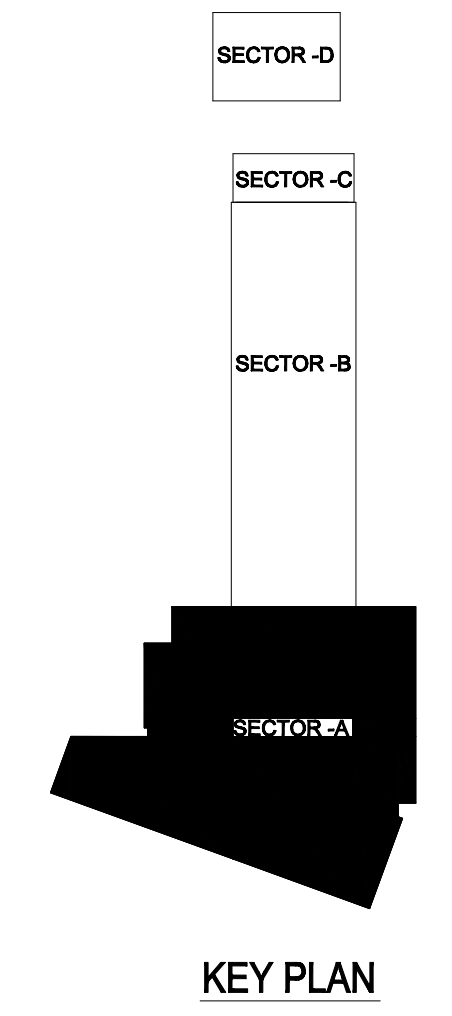